

The Taylor Yard Rainwater Harvesting Solution

Meeting Stormwater Regulations and Saving Water



Dirty stormwater goes to a CDS for pre-treatment.



The Contech CDS Hydrodynamic separation provides pretreatment of stormwater flows from the site & prevents trash/debris/leaves from collecting in tank. This reduces stagnation and odor and protects downstream components.



Treated stormwater is stored in cisterns and stormwater goes to a CDS for treatment.



A dual purpose Contech system provides detention and rain water harvesting. The 10 foot diameter metal pipe system provides detention of 46,500 cubic feet of water. The 10 foot diameter rainwater harvesting cisterns (the black Duromaxx HDPE system) provides 168,300 gallons of storage for irrigation. The system meets the stormwater requirements for matching predevelopment flows and the stormwater quality requirements by preventing polluted water runoff from the site.

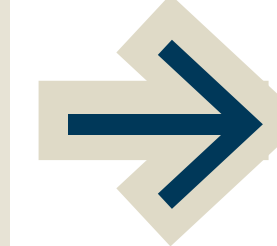

Clean water from tanks goes to the irrigation system.



The mechanical skid includes the controls for delivering water from tank to irrigation.



LOT 7 Rainwater Harvesting Site Layout

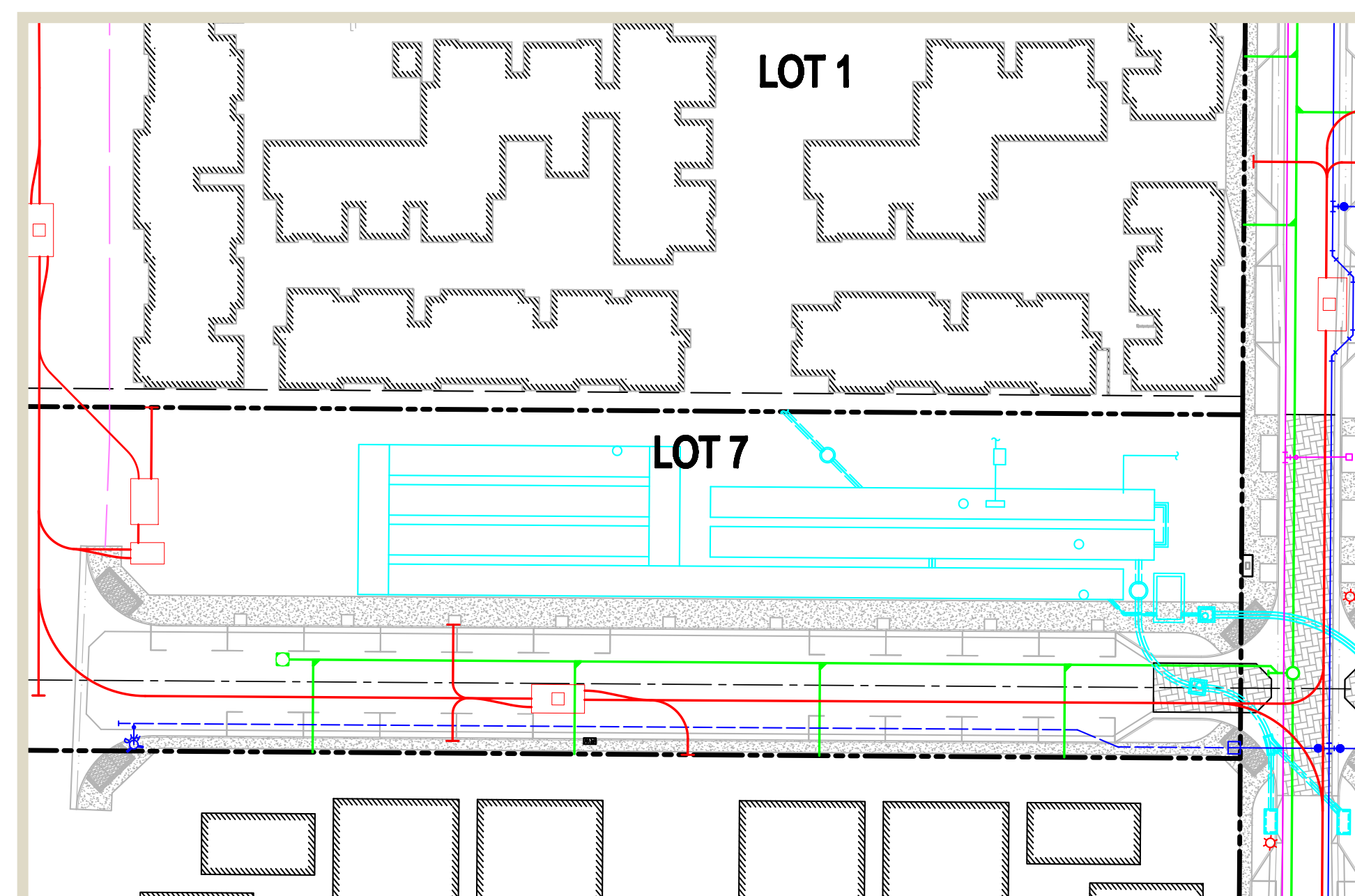

Overflow water goes to CDS and StormFilter for treatment prior to release.

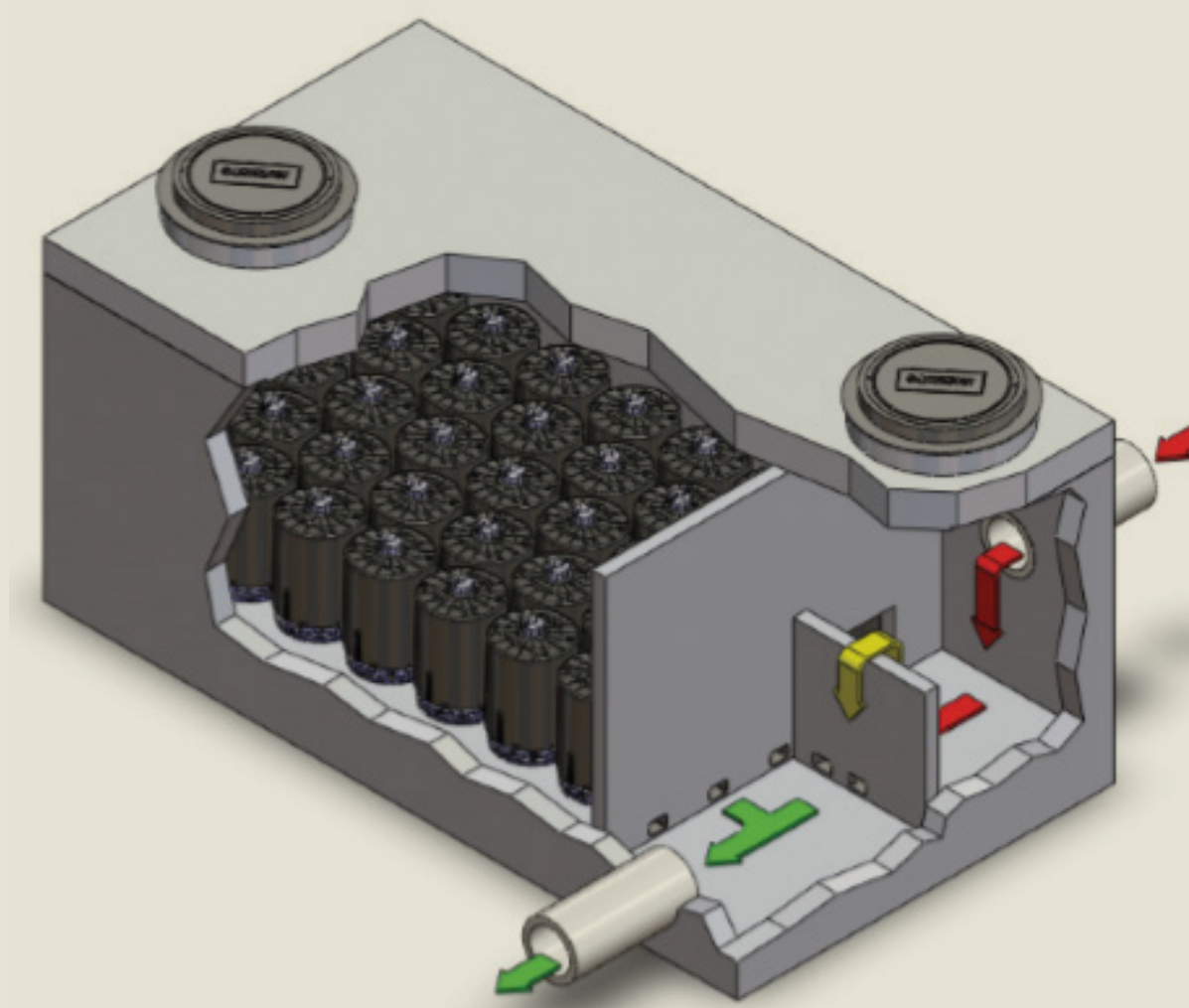

The Contech Stormwater Management StormFilter® uses media filled cartridges for removal of dissolved pollutants (metals, nutrients, bacteria, fine sediment) from the overflow.

**MCCORMACK
BARON
SALAZAR**

 Hall & Foreman, Inc.

CONTECH
ENGINEERED SOLUTIONS